

## MAXI FRAME TOTEM WITH LED DOUBLE SIDED

MAXI  
frame



### FLOOR STANDING FRAME SOLUTIONS FOR BIG FABRIC POSTERS!

Double sided LED Maxi Totem promotes the message with high and even illumination. Pre-treated light guided panel diffuses light even and powerfully. LED illumination saves up to 60% energy costs (compared to fluorescent technology).

### KEY SELECTION ATTRIBUTES

- \* A very modern and slim design, double-sided, floor standing, edge-lit Maxi Frame Totem system, combining long lasting LED technology bulbs, aluminium profile and sewed or nylon strip for application of printed fabric posters.
- \* One of the most attractive frame designs in the market with frameless look when viewed from the front and back sides.
- \* Suitable for INDOOR applications with 594x1682mm standard poster size.
- \* Provides homogenous and powerful illumination. Offers evenly diffused lux for the standard size. 2100 to 2600 lux of luminance is achieved.
- \* LED bulbs are not seen from outside, since they are embedded in sides of the frame.
- \* Do not subject the product to outdoor, high humid and vaporized area. Keep the product out of direct rays of sun. Keep away from the fire or severe hot place. Acceptable ambient temperature is max 35°C.
- \* Maxi Frame Totem with LED Double Sided can be ordered in one standard size. They can also be ordered in special lengths and parts as semi products. Maximum size is 2500x6000mm.
- \* Supplied with quality certificates and CE/UL PAT test reports passed.
- \* Natural silver-anodized aluminium frame and RAL 9006 powder coated steel base in standard and various RAL colors available with antimicrobial powder coating. Subject to MOQ.
- \* One set includes a double sided aluminium profile frame with 50mm depth and embedded LED bulbs; 3mm clear nylon strips; 380x700mm sheet metal base with 6mm thickness and RAL9006 powder coating; one on/off switch on frame; 2 flange connections and bolts for installation; 1 power supply with cable and 1 EU Plug. UK and US plugs are available, should be specified with order. All electrical components are CE listed.
- \* Fabric is not included in the original pack.
- \* Recommended fabric thickness for digital printing is 0,5mm. Thickness of the profile is 4mm. Thickness of nylon strip is 3mm. The pull sticker in 0,5mm thickness must be sewed on the fabric for taking out the poster when fitted into the channels.
- \* 13mm on each side of the fabric into Maxi Profiles, so 26mm on each Fabric Poster is not seen on the poster. Please arrange accordingly.
- \* Additional print shares suggested for Maxi Frame's Fabric Posters: 28mm between 200-750mm, 20mm between 750-1500mm, 15mm between 1500-3000mm. These values might vary according to the fabric used.
- \* Profiles and connector parts of Maxi Frame Totem with LED Double Sided for the required sizes are packed unassembled in a single box with an easy mounting instruction sheet. Fixing tools are included in each frame.
- \* Products are suitable to use 7/16. For using the LED frame for 24 hours a day and 7 days a week, please ask for special 7/24 power supplies.

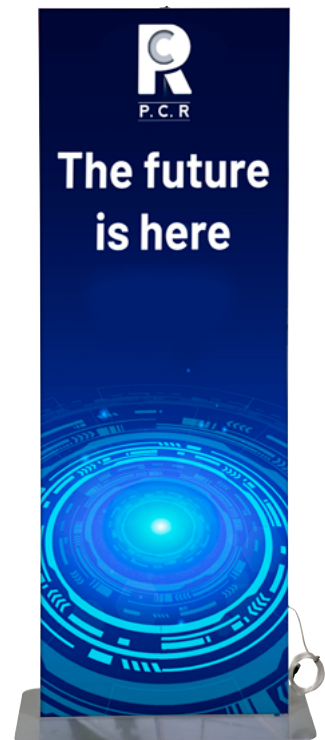

## COLOURS IN STOCK



Silver

## SUITABLE FOR

Maxi Frame Totem can be used for INDOOR applications, for signage needs in many locations like shopping centers, markets, groceries, hotels, offices, airports, shops and stores, hospitals, schools, apartments, banks, car dealers, restaurants, telecom companies, insurance companies, libraries, museums, travel agencies and many more.

## WATCH VIDEO



Watch video at our website [www.mtdisplays.com](http://www.mtdisplays.com)

## FEATURES



## TECHNICAL DRAWING

### EXPLODED VIEW

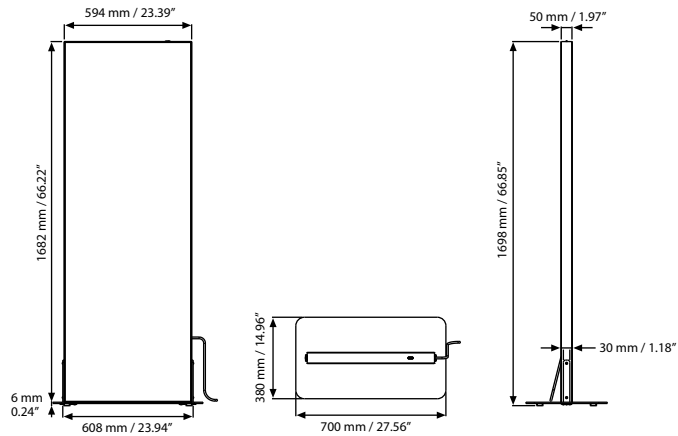
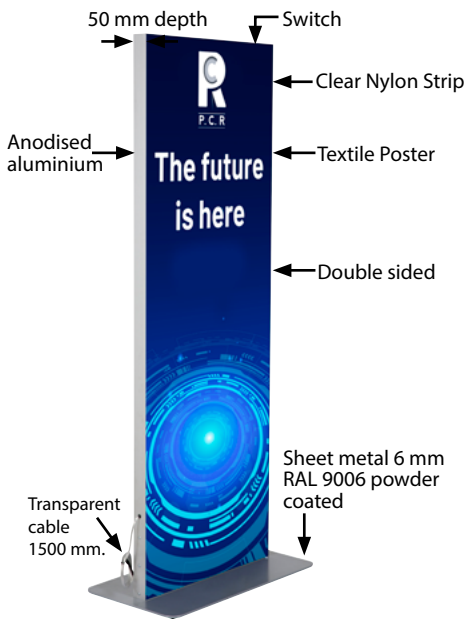

### Application of nylon strip by sew-on process

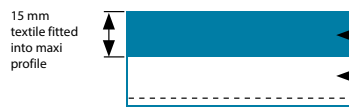

### Application of nylon strip by double sided tape



## ARTICLES

ARTICLE	EXTERNAL (x-y)	POSTER	LIGHTING	WEIGHT	PACKING SIZE
				WITH PACKING	*W X H X D
UMTSLNO2A1	594 mm	594 X 1682 mm	2100-2600 LUX	14 kg/13,6 kg	625 X 1800 X 90 / 400 X 720 X 25 mm

MAXIMUM SIZE: 2500X6000 mm

## COMPONENTS OF MAXI FRAMES



Clear Nylon Strip  
13 x 3 mm, 100 meters.  
UYUP460235



Clear Nylon Strip with  
tape 13 x 3 mm, 50  
meters. UYUP460220



T: +90 850 433 67 85 / [info@mtdisplays.com](mailto:info@mtdisplays.com) / [www.mtdisplays.com](http://www.mtdisplays.com)

## PHYSICAL DATA

### Material

Aluminium profile frame with 50mm depth, 36x19mm aluminium H-profile, clear nylon strips, metal connectors, powder coated steel base.

### Surface Finish

Natural silver-anodized aluminium frame and RAL 9006 powder coated steel base in standard and various RAL colors available with antimicrobial powder coating. Subject to MOQ. Call for custom color requests.

### Storage Conditions

Goods should be stored at 0° to 25°C in a dry place. Store in the original package.

### Recycled Content

Up to %78 recycled content used.

### Warranty

All products are guaranteed for 3 years by MT Displays with below conditions:

[Warranty Conditions](#)

### Poster Material & Thickness

Recommended fabric thickness for digital printing is 0,5mm. Thickness of the channel is 4mm.

Thickness of nylon strip is 3mm. The pull sticker in 0,5mm thickness must be sewed on the fabric to take out the poster from channels.

### Installation Considerations

Profiles and connector parts of Maxi Frame Totem with LED Double Sided for the required sizes are packed unassembled in a single box with an easy mounting instruction sheet. Supplied with quality certificates and CE/UL PAT test reports passed. One set includes a double sided aluminium profile frame with 50mm depth and embedded LED bulbs; 3mm clear nylon strips; 380x700mm sheet metal base with 6mm thickness and RAL9006 powder coating; one on/off switch on frame; 2 flange connections and bolts for installation; 1 power supply with cable and 1 EU Plug. UK and US plugs are available, should be specified with order. All electrical components are CE listed. Fixing tools are included in each frame. Fabric is not included in the original pack. 13mm on each side of the fabric into Maxi Profiles (in total 26mm on each Fabric Poster) is not seen on the poster. Please arrange accordingly. Additional print shares suggested for Maxi Frame's Fabric Posters: 28mm between 200-750mm, 20mm between 750-1500mm, 15mm between 1500-3000mm. These values might vary according to the fabric used. Maxi Frame Totem with LED Double Sided can be ordered in one standard size. They can also be ordered in special lengths and parts as semi products. Maximum size is 2500x6000mm.

### Design Considerations

A very modern and slim design, double-sided, floor standing, edge-lit Maxi Frame Totem system, combining long lasting LED technology bulbs, aluminium profile and sewed or nylon strip for application of printed fabric posters. One of the most attractive frame designs in the market with frameless look when viewed from the front and back sides. Suitable for INDOOR applications with 1000x2000mm, 1000x3000mm, 1500x2000mm, 1500x3000mm, 2000x2000mm and 2000x3000mm poster sizes. Suitable for INDOOR applications with 594x1682mm standard poster size. Provides homogenous and powerful illumination. Offers evenly diffused lux for the standard size. 2100 to 2600 lux of luminance is achieved. LED bulbs are not seen from outside, since they are embedded in sides of the frame. Do not subject the product to outdoor, high humid and vaporized area. Keep the product out of direct rays of sun. Keep away from the fire or severe hot place. Acceptable ambient temperature is max 35°C.

### Cleaning and Disinfecting

Clean your displays, with damp microfiber clothes, rinsed with simply water or warm, soapy or gentle shampooed water. Avoid using vinegar, abrasive, acidic, alcohol-based or heavy cleaners or cleaners containing Ammonia. Only after cleaning the product, if needed, simply apply disinfectant or sanitizer that is in compliance with your local guidelines and regulations.

### Cleaning and Disinfecting

CE/UL Patent approved.

## PRINT TEMPLATES

### Maxi Frame Totem with LED Double Sided - 594x1682 mm

Document Size: 654 x 1742 mm (Includes Bleeds)

Finished Size: 594 x 1682 mm [Print](#)



# INSTALLATION INSTRUCTIONS

## Maxi Frame Totem with LED Double Sided / 1010284H000

Each product package

includes

- 1 x Base
- 1 x Main body
- 2 x Flange connection
- 6 x Bolt M5x10
- 4 x Bolt M5x16
- 1 x Power supply
- 1 x EU Plug

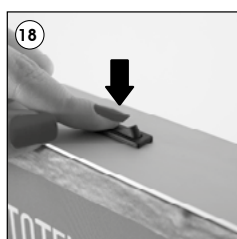
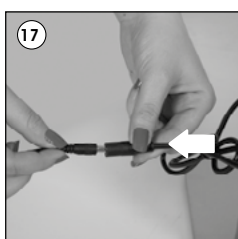
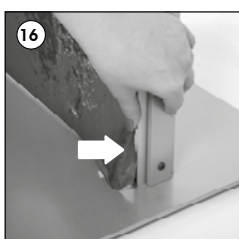
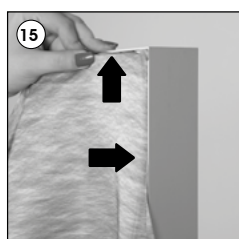
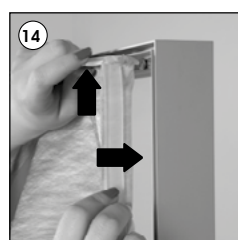
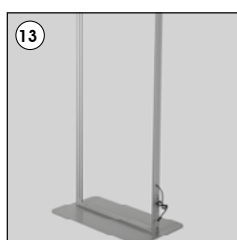
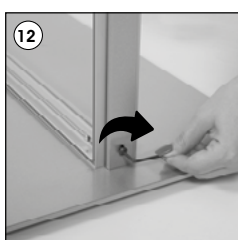
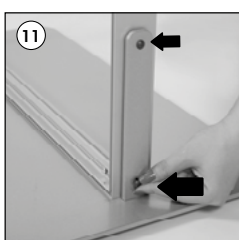
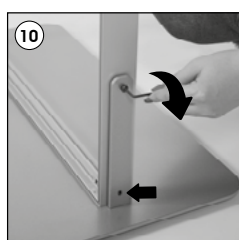
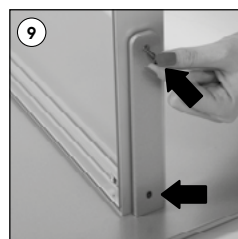
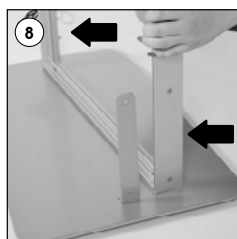
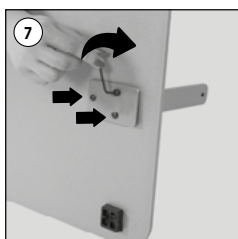
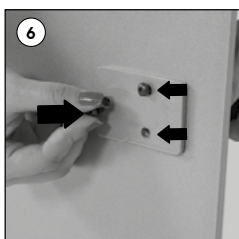
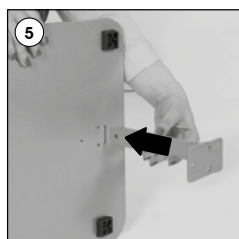
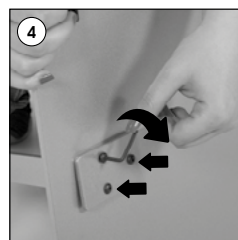
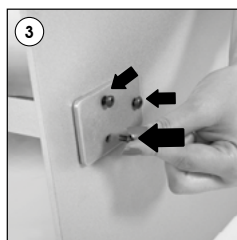
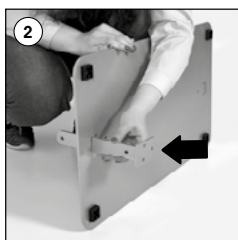
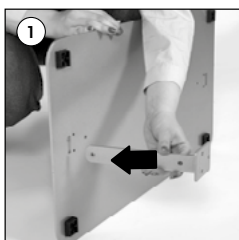

### Caution!

- 1- Do not step on the light panel nor place the heavy object on the light panel.
- 2- Do not pull the cable with excessive force.
- 3- Use correct capacity and voltage of D.C. power supply.  
Failure to observe this instruction could result in breakdown.
- 4- Do not touch the light panel or electrical devices with wet hand. Failure to observe this instruction could result in electrical shocks and severe injuries.
- 5- Do not subject this light panel to outdoor, high humid and vaporized area.  
Failure to observe this instruction could result in breakdown.
- 6- Keep this out of the direct rays of the sun. Failure to observe this instruction could result in color changes of acrylic plate.
- 7- Keep away from fire or severe hot place. Acceptable ambient temperature is max.35°C Failure to observe this instruction could result in shorten the life time and degradation of brightness of LED light source.

- Please inform the order number on the product or on the carton (e.g. 1/110001394-460) to the place that you have made the purchase if any problem with the product occurs.
- All rights reserved. All pictures, figures and writings are secured internationally by copy-right law. Infringements will be sued by civil and legal law.



This technical sheet's contents are all subject to update and modification at MT Displays' exclusive discretion. There is nothing official about this document. For final and legally binding information, please get in touch with the sales staff at MT Displays.



T: +90 850 433 67 85 / info@mtdisplays.com / www.mtdisplays.com