

TOTEM



DOUBLE-SIDED FREE-STANDING LIGHT COLUMNS WITH EASY SNAP OPEN DESIGN

Stylish and practical free-standing light column. Illuminates posters printed on backlit film or duratrans. The snap frames enable you to change the display material easily whenever desired. Product is double sided. One can simply open the front profile to change the poster. The hinged door, magnetic cover closing & plastic pegs on both sides add value to the unit provide easy poster replacement.

KEY SELECTION ATTRIBUTES

- * Double-sided, curved design, free-standing, back-lit light column equipped with long lasting LED technology bulbs.
- * Front loading frames with snap open pressure profiles on long sides, PVC hinges on one side, magnetic covers & plastic pegs on both sides for easy poster replacement.
- * Highly powerful and even illumination is achieved with long lasting LED technology bulbs, opal acrylic poster backings and anti-reflex PET poster covers for illuminating the posters without shining. Posters are interlaced among the acrylic backings and PET poster covers on both sides.
- * Illumination save up to 60% energy cost with an increased life expectancy.
- * Suitable for INDOOR applications with 600x1700mm, 700x1700mm, 800x1700mm poster sizes.
- * One set includes a double sided totem body and 36mm snap open aluminum frame profiles with magnetic tapes and 64mm depth on long sides; back-lit designed LED bulbs; 2 opal acrylic backings to diffuse light across graphics; 2 matt/clear anti-reflex magnetic PET poster covers; pegs to hold posters; 1 powder coated top plate and 1 powder coated heavy steel baseplate for stability; ventilation holes on top and bottom plates; 1 Allen Key (4), 1 Allen Key (5), 6 SB Bolts, 6 HB Bolts, 1 power adapter with 1,5 meter long cable and 1 EU Plug. UK and US plugs are available, should be specified with order. Has no switch.
- * Supplied with quality certificates and CE/UL PAT test reports passed.
- * RAL9006 grey powder coated main body in standard and various RAL colors available with antimicrobial powder coating.
- * Backlit film or translucent poster material should be used for printing the signage.
- * Packed unassembled in 2 boxes with an easy mounting instruction sheet. See info chart for pack sizes.



COLOURS IN STOCK



Silver

COLOUR OPTIONS

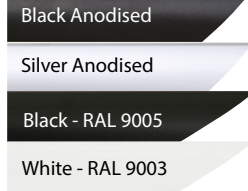

SUITABLE FOR

Totem Light Columns can be used for a wide range of INDOOR applications, for signage needs in many locations like retail point-of-purchase, tradeshow displays, movie theatres, sports facilities, shopping malls, markets, groceries, hotels, airports, shops and stores, hospitals, restaurants, halls, meeting, rooms, gas stations, casinos, and more.

WATCH VIDEO



Watch video at our website
www.mtdisplays.com

FEATURES



Pegs to hold poster

Ventilation holes

EXPLODED VIEW



TECHNICAL DRAWING

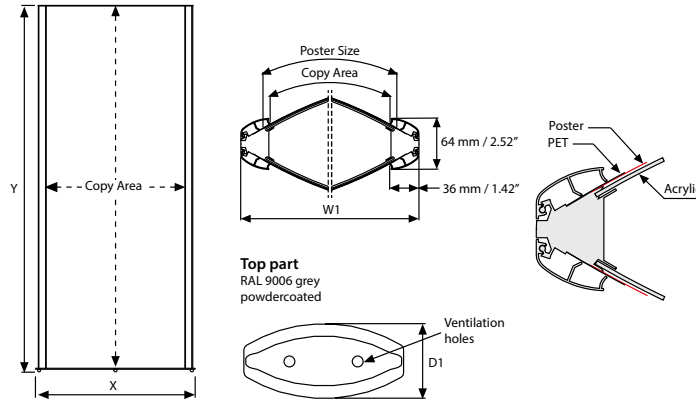

ARTICLES

ARTICLE	EXTERNAL (x-y)	POSTER	COPY	D1	W1	LIGHTING	WEIGHT	PACKING SIZE
							WITH PACKING	*W X H X D
UTTM001000	650 X 1720 mm	600 X 1700 mm	580 X 1700 mm	350 mm	628 mm	1 X 58 W	28,000 kg	670 X 1750 X 85 mm / 380 X 680 X 45 mm
UTTM002000	750 X 1720 mm	700 X 1700 mm	680 X 1700 mm	350 mm	723 mm	1 X 58 W	30,800 kg	770 X 1750 X 85 mm / 380 X 780 X 45 mm
UTTM003000	850 X 1720 mm	800 X 1700 mm	780 X 1700 mm	370 mm	820 mm	2 X 58 W	36,500 kg	870 X 1750 X 85 mm / 400 X 880 X 45 mm
UTTM002767	28.97" X 68.97"	27" X 67"	26.21" X 66.21"	13.58"	29.13"	2700-3300 LUX	65.106 lbs	30,91" X 46.06" X 3.74" / 14.57" X 30.12" X 1.57"
UTTM002777	28.97" X 78.97"	27" X 77"	26.21" X 76.21"	13.58"	29.13"	2700-3300 LUX	71.500 lbs	30.91" X 80.71" X 3.35" / 14.57" X 30.12" X 1.57"



T: +90 850 433 67 85 / info@mtdisplays.com / www.mtdisplays.com

PHYSICAL DATA

Material

Totem body with 36mm aluminium profile snap open frames with magnetic tapes and 64 mm depth, opal acrylic backings, magnetic PET anti-reflex poster covers, LED bulbs, steel top and baseplates.

Poster Material

Backlit film or translucent poster material should be used for printing the signage.

Surface Finish

RAL9006 grey powder coated in standard and various RAL colors available with antimicrobial powder coating. Call for custom color requests.

Warranty

All products are guaranteed for 2 years by MT Displays with below conditions:

[Warranty Conditions](#)

Storage Conditions

Goods should be stored at 0° to 25°C in a dry place. Store in the original package.

Installation Considerations

Totem Light Columns are packed unasssembled in 2 boxes with an easy mounting instruction sheet. See info chart for pack sizes. Supplied with quality certificates and CE/UL PAT test reports passed. One set includes a double sided totem body and 36mm snap open aluminum frame profiles with magnetic tapes and 64mm depth on long sides; LED bulbs for back-lit design; 2 opal acrylic backings to diffuse light across graphics; 2 matt/clear anti-reflex magnetic PET poster covers; pegs to hold posters; 1 powder coated top plate and 1 powder coated heavy steel baseplate for stability; ventilation holes on top and bottom plates; 1 Allen Key (4), 1 Allen Key (5), 6 SB Bolts, 6 HB Bolts, 1 power adapter with 1,5 meter long cable and 1 EU Plug. UK and US plugs are available, should be specified with order. Has no switch.

Design Considerations

Double-sided, curved design, free-standing, backlit light column equipped with long lasting LED technology bulbs. Front loading frames with snap open pressure profiles on long sides, PVC hinges on one side, magnetic covers & plastic pegs on both sides for easy poster replacement. Highly powerful and even illumination is achieved with long lasting LED technology bulbs, opal acrylic poster backings and anti-reflex PET poster covers for illuminating the posters without shining. Posters are interlaced among the acrylic backings and PET poster covers on both sides. Suitable for INDOOR applications with 600x1700mm, 700x1700mm and 800x1700mm poster sizes. Illumination save up to 60% energy cost with an increased life expectancy.

Cleaning and Disinfecting

Clean your displays, with damp microfiber clothes, rinsed with simply water or warm, soapy or gentle shampooed water. Avoid using vinegar, abrasive, acidic, alcohol-based or heavy cleaners or cleaners containing Ammonia. Only after cleaning the product, if needed, simply apply disinfectant or sanitizer that is in compliance with your local guidelines and regulations.

PRINT TEMPLATES

Mono Totem - 600 x 1700 mm

Document Size: 610 x 1710 mm (Includes Bleeds)

Finished Size: 600 x 1700 mm [Print](#)

Mono Totem - 700 x 1700 mm

Document Size: 710 x 1710 mm (Includes Bleeds)

Finished Size: 700 x 1700 mm [Print](#)

Mono Totem - 800 x 1700 mm

Document Size: 810 x 1710 mm (Includes Bleeds)

Finished Size: 800 x 1700 mm [Print](#)

Mono Totem - 27" x 67"

Document Size: 27.4" x 67.4" mm (Includes Bleeds)

Finished Size: 27" x 67"

Mono Totem - 27" x 77"

Document Size: 27.4" x 77.4" mm (Includes Bleeds)

Finished Size: 27" x 77"

ILLUMINATED PRODUCTS TECHNICAL MANUAL

CABLE

Delivered with 2 meter long cable and EU plug. UK, US or CH plugs should be specified with order.



FEATURES

- Easy poster change.
- Magnetic door like poster cover.

TECHNICALS PECIFICATION

ARTICLE	POSTERI	LLUMINATION	POWER CONSUMPTION	POWER
UTTM001000	600 X 1700 mm	1 X 58 W	58 WA	C 230 V
UTTM002000	700 X 1700 mm	1 X 58 W	58 WA	C 230 V
UTTM003000	800 X 1700 mm	2 X 58 W	116 WA	C 230 V

FLUORESCENT FEATURES (FT8/58W/860/GE/SL1/25)

Color: 6400 K (white)

CRI: 84

Luminous Flux: Typ. 5000 lm @ 6400 K

Luminous efficacy: Typ. 86 lm/W @ 6400 K

Life Time: 20.000 Hours



ASSEMBLY SHEET



INSTALLATION INSTRUCTIONS

Totem / 1011063H000

Each product package includes

- 1 x Totem base
 - 1 x Totem top plate
 - 1 x Totem main body
 - 2 x PET Cover
 - 2 x Opaque Acrylic cover
 - 1 x 4 Allen key
 - 1 x 5 Allen key
- 6 x Bolt SB M6x25
 - 6 x Bolt HB M6x25
 - 1 x Ballast Electronic 1x58W

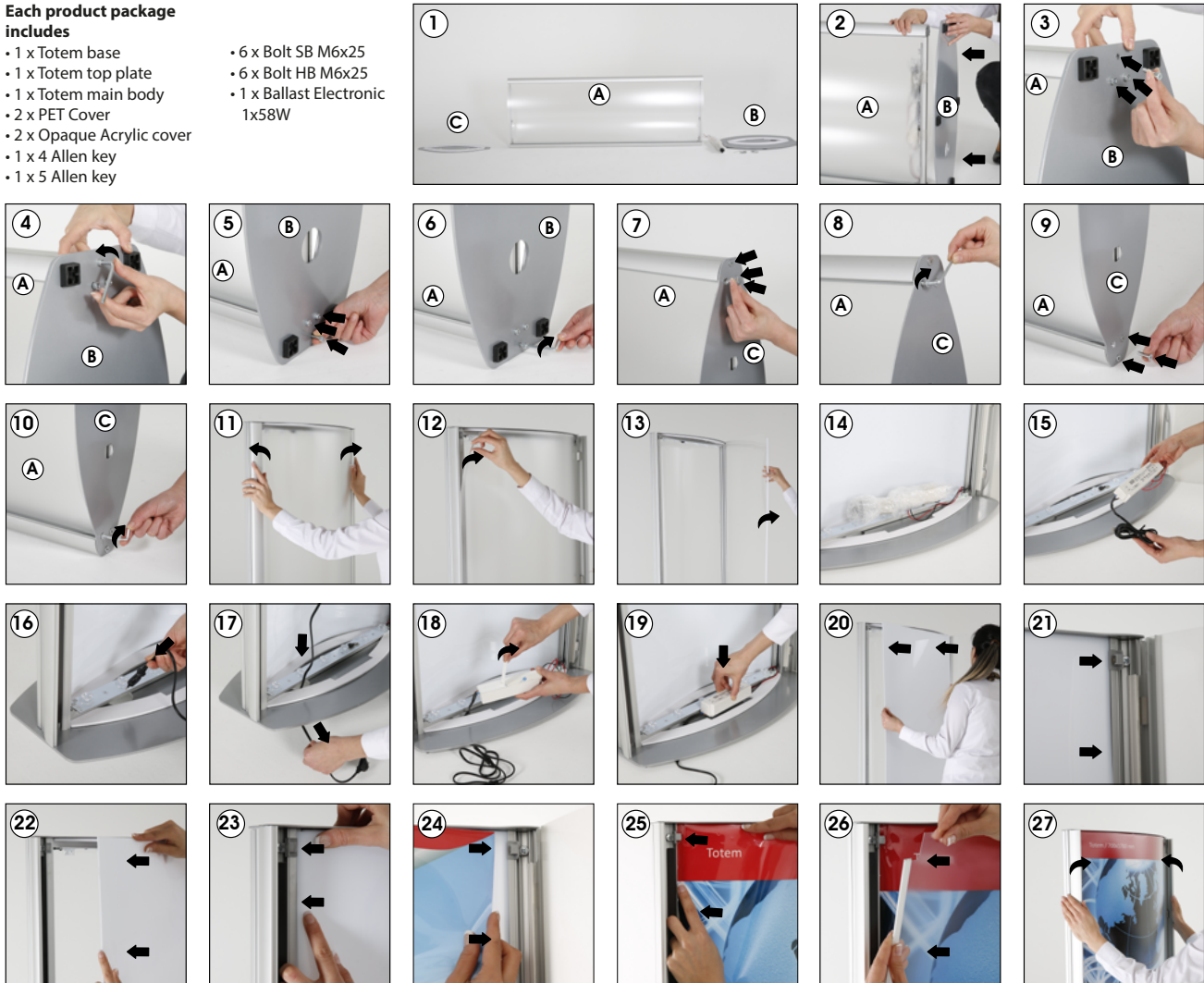

- Please inform the order number on the product or on the carton (e.g. 1/110001394-460) to the place that you have made the purchase if any problem with the product occurs.
- All rights reserved. All pictures, figures and writings are secured internationally by copy-right law.
- Infringements will be sued by civil and legal law.

This technical sheet's contents are all subject to update and modification at MT Displays' exclusive discretion. There is nothing official about this document. For final and legally binding information, please get in touch with the sales staff at MT Displays.



T: +90 850 433 67 85 / info@mtdisplays.com / www.mtdisplays.com