

LUMI MAXI TOTEM WITH LED DOUBLE SIDED

MAXI
frame

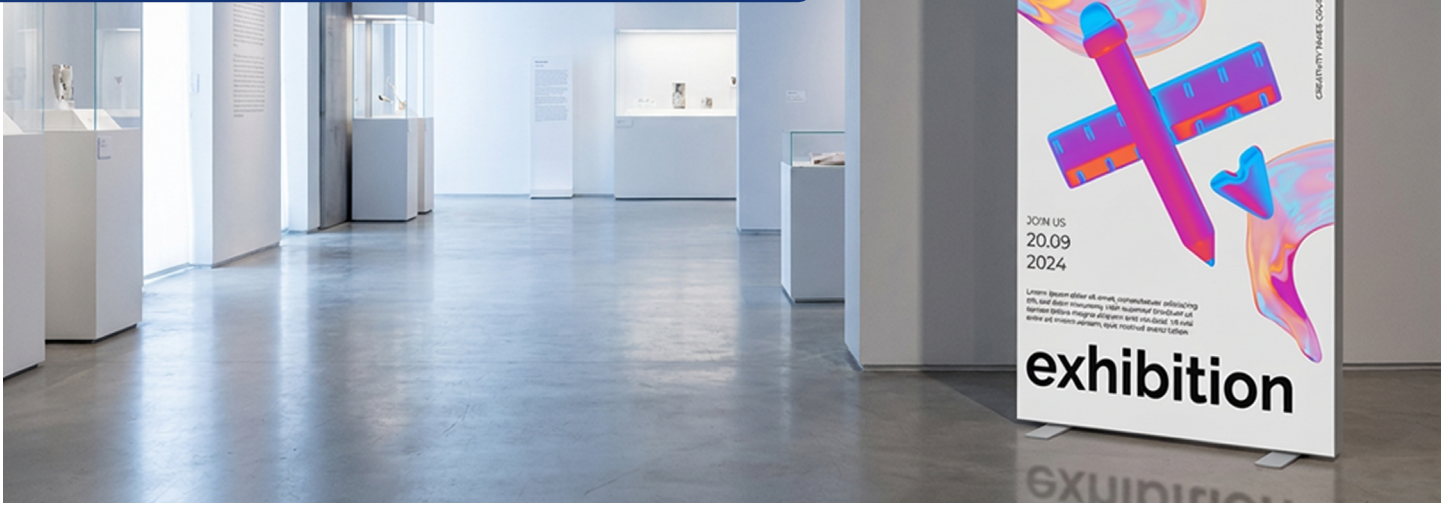

FLOOR STANDING FRAME SOLUTIONS FOR BIG FABRIC POSTERS!

Double-sided Lumi Maxi Totem delivers high-impact message visibility with uniform, high-intensity illumination. Integrated LED technology provides evenly diffused light across both vertical long sides, ensuring consistent brightness from top to bottom. The advanced LED system reduces energy consumption by up to 60% compared to conventional fluorescent lighting solutions.

KEY SELECTION ATTRIBUTES

- * A very modern and slim design, double-sided, floor standing, vertical side-lit Maxi Totem system, combining long lasting LED technology bulbs, aluminium profile and sewed or nylon strip for application of printed fabric posters.
- * One of the most attractive frame designs in the market with frameless look when viewed from the front and back sides.
- * Suitable for INDOOR applications with 800x2000mm and 1000x2000mm standard poster sizes.
- * Provides homogenous and powerful illumination. 10.000K LED integrated technology. Offers evenly diffused lux for the standard size.
- * LED bulbs are not seen from outside, since they are embedded in vertical sides of the frame.
- * Do not subject the product to outdoor, high humid and vaporized area. Keep the product out of direct rays of sun. Keep away from the fire or severe hot place. Acceptable ambient temperature is max 35°C.
- * Lumi Maxi Totem with LED Double Sided can be ordered in two different size options. They can also be ordered in special lengths and parts as semi products. Maximum size is 1000x2000mm.
- * Supplied with quality certificates and CE/UL PAT test reports passed.
- * Natural silver-anodized aluminium frame and RAL 9006 powder coated steel feet in standard and various RAL colors available with antimicrobial powder coating. Subject to MOQ.
- * One set includes a double sided aluminium profile frame with 80mm depth and embedded LED bulbs only on long vertical sides; 3mm clear nylon strips; 400mm long sheet metal feet with 5mm thickness and RAL9006 powder coating 2 flange connections and bolts for installation; 1 power supply with cable and 1 EU Plug. UK and US plugs are available, should be specified with order. All electrical components are CE listed.
- * Fabric is not included in the original pack.
- * Recommended fabric thickness for digital printing is 0,5mm. Thickness of nylon strip is 3mm. The pull sticker in 0,5mm thickness must be sewed on the fabric for taking out the poster when fitted into the channels.
- * 15mm on each side of the fabric into Lumi Profiles, so 30mm on each Fabric Poster is not seen on the poster for sew-on applications. Please arrange accordingly.
- * Additional print shares suggested for Lumi Fabric Posters: 60mm for double sided tape applications. These values might vary according to the fabric used.
- * Profiles and connector parts of Lumi Maxi Totem with LED Double Sided for the required sizes are packed semi-assembled in a single box with an easy mounting instruction sheet. Fixing tools are included in each frame.
- * Products are suitable to use 7/16. For using the LED frame for 24 hours a day and 7 days a week, please ask for special 7/24 power supplies.



COLOURS IN STOCK



Silver

SUITABLE FOR

Lumi Maxi Totem can be used for INDOOR applications, for signage needs in many locations like shopping centers, markets, groceries, hotels, offices, airports, shops and stores, hospitals, schools, apartments, banks, car dealers, restaurants, telecom companies, insurance companies, libraries, museums, travel agencies and many more.

WATCH VIDEO



Watch video at our website www.mtdisplays.com

FEATURES



EXPLODED VIEW

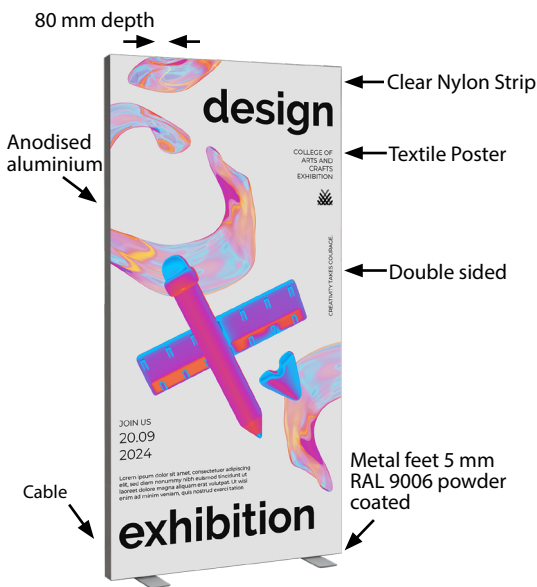

TECHNICAL DRAWING

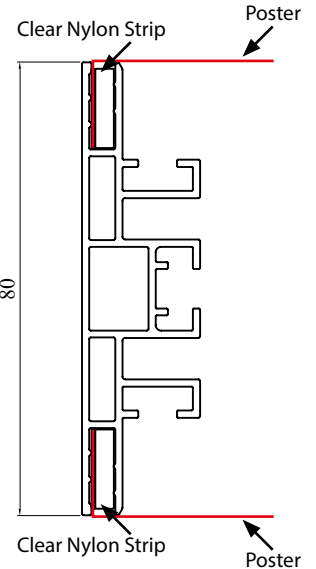
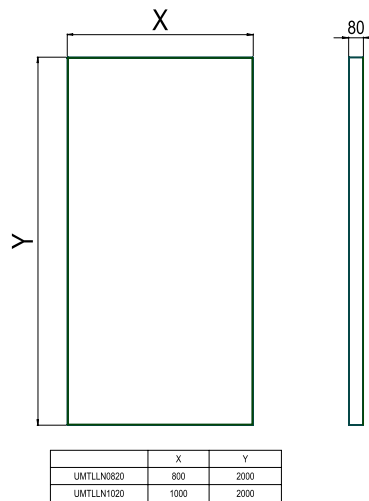

Application of nylon strip by sew-on process



Application of nylon strip by double sided tape



COMPONENTS OF LUMI MAXI

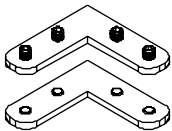

Corner Cleat for Maxi Frame with LED.
Packed by 8.
UYUP412295



Clear Nylon Strip
13 x 3 mm, 100 meters.
UYUP460235



Clear Nylon Strip with tape
13 x 3 mm, 50 meters.
UYUP460220



Led Modules 3-S5 LED



Power Supplies
90W-160W

ARTICLES

ARTICLE	EXTERNAL (x-y)	LIGHTING	WEIGHT	PACKING SIZE
			WITH PACKING	*W X H X D
UMTLLN0820X2000	800X2000mm	1500-1900 LUX	9,4 kg	155 x 2060 x 95 mm
UMTLLN1020X2000	1000X2000mm	1500-1900 LUX	9,8 kg	155 x 2060 x 95 mm



T: +90 850 433 67 85 / info@mtdisplays.com / www.mtdisplays.com

FEET OF LUMI MAXI



FLAT FEET - RAL 9006 Powder coated metal feet.	
SIZE	WEIGHT
400 X 80 X 5 mm	1,25 kg

PHYSICAL DATA

Material

Aluminium profile frame with 80mm depth, clear nylon strips, metal connectors, powder coated steel feet.

Surface Finish

Natural silver-anodized aluminium frame and RAL 9006 powder coated steel base in standard and various RAL colors available with antimicrobial powder coating. Subject to MOQ. Call for custom color requests.

Storage Conditions

Goods should be stored at 0° to 25°C in a dry place. Store in the original package.

Recycled Content

Up to %78 recycled content used.

Warranty

All products are guaranteed for 2 years by MT Displays with below conditions:

[Warranty Conditions](#)

Poster Material & Thickness

Recommended fabric thickness for digital printing is 0,5mm. Thickness of the channel is 4mm.

Thickness of nylon strip is 3mm. The pull sticker in 0,5mm thickness must be sewed on the fabric to take out the poster from channels.

Installation Considerations

Profiles and connector parts of Lumi Maxi Totem with LED Double Sided for the required sizes are packed semi-assembled in a single box with an easy mounting instruction sheet. Fixing tools are

included in each frame. Supplied with quality certificates and CE/UL PAT test reports passed. One set includes a double sided aluminium profile frame with 80mm depth and embedded LED bulbs only on long vertical sides; 3mm clear nylon strips; 400mm long sheet metal feet with 5mm thickness and RAL9006 powder coating; 2 flange connections and bolts for installation; 1 power supply with cable and 1 EU Plug. UK and US plugs are available, should be specified with order. All electrical components are CE listed. Fixing tools are included in each frame. Fabric is not included in the original pack. 15mm on each side of the fabric into Lumi Maxi Profiles (in total 30mm on each Fabric Poster) is not seen on the poster for sew-on applications. Please arrange accordingly. Additional print shares suggested for Lumi Maxi Fabric Posters: 60mm for double sided tape applications. These values might vary according to the fabric used. Lumi Maxi Totem with LED Double Sided can be ordered in two different size options. They can also be ordered in special lengths and parts as semi products. Maximum size is 1000x2000mm.

Design Considerations

A very modern and slim design, double-sided, floor standing, edge-lit Maxi Frame Totem system, combining long lasting LED technology bulbs, aluminium profile and sewed or nylon strip for application of printed fabric posters. One of the most attractive frame designs in the market with frameless look when viewed from the front and back sides. Suitable for INDOOR applications with 800x2000mm and 1000x2000mm standard poster sizes. Provides homogenous and powerful illumination. 10.000K LED integrated technology.

Offers evenly diffused lux for the standard size. LED bulbs are not seen from outside, since they are embedded in sides of the frame. Do not subject the product to outdoor, high humid and vaporized area. Keep the product out of direct rays of sun. Keep away from the fire or severe hot place. Acceptable ambient temperature is max 35°C.

Cleaning and Disinfecting

Clean your displays, with damp microfiber clothes, rinsed with simply water or warm, soapy or gentle shampooed water. Avoid using vinegar, abrasive, acidic, alcohol-based or heavy cleaners or cleaners containing Ammonia. Only after cleaning the product, if needed, simply apply disinfectant or sanitizer that is in compliance with your local guidelines and regulations.

Hazardous Substances

M&T Displays prioritizes compliance with the REACH (Registration, Evaluation, Authorisation and Restriction of Chemicals) and RoHS (Restriction of Hazardous Substances) directives to protect both the environment and human health. We ensure that our products do not contain substances listed under REACH and adhere to strict RoHS limits for hazardous materials. Our manufacturing process ensures that lead, mercury, cadmium, and other restricted substances remain within the permitted thresholds, guaranteeing safe and sustainable products for our customers.

Certifications / Patents

CE/UL Patent approved.

PRINT TEMPLATES

Lumi Maxi Totem with LED Double Sided - 800x2000mm

Document Size: 860x2060mm (Includes Bleeds)

Finished Size: 800x2000mm [Print](#)

Lumi Maxi Totem with LED Double Sided - 1000x2000mm

Document Size: 1060x2060mm (Includes Bleeds)

Finished Size: 1000x2000mm [Print](#)



INSTALLATION INSTRUCTIONS

Lumi Maxi Totem with LED Double Sided

Each product package includes

- 2 x Feet
- 1 x Main body Shipped Unassembled
- 4 x Bolt M6x25
- 1 x Allen Key (5)
- 1 x Allen Key (2.5)
- 8 x Corner Bracket
- 1 x Power supply
- 1 x EU Plug

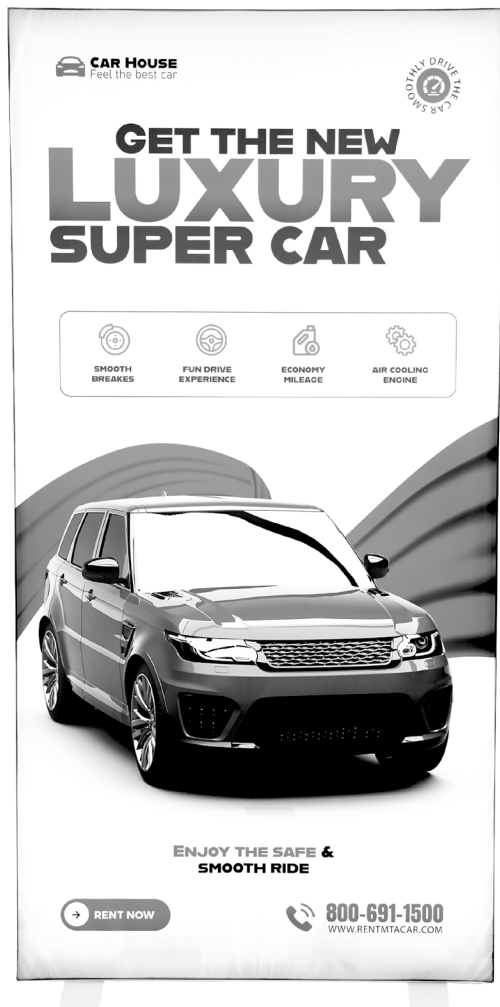
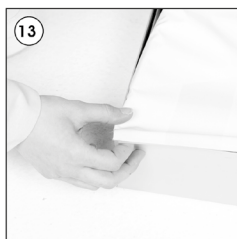
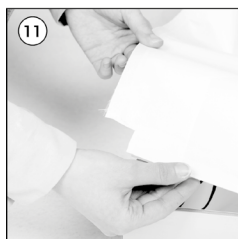
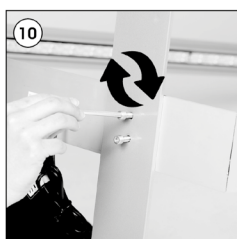
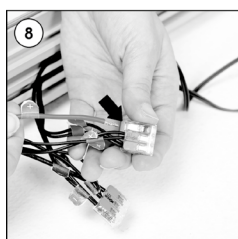
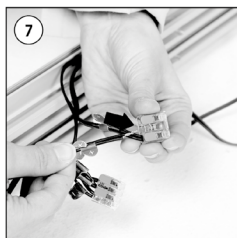
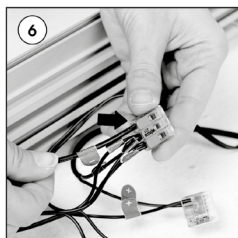
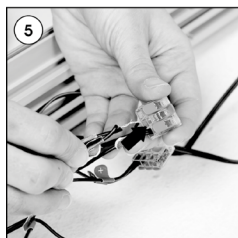
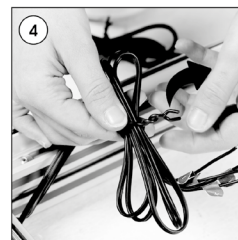
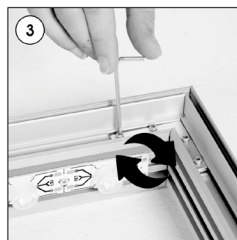
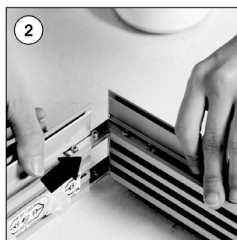
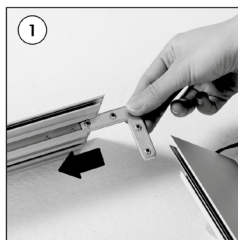

Caution!

- 1- Do not step on the light panel nor place the heavy object on the light panel.
- 2- Do not pull the cable with excessive force.
- 3- Use correct capacity and voltage of D.C. power supply.
Failure to observe this instruction could result in breakdown.
- 4- Do not touch the light panel or electrical devices with wet hand. Failure to observe this instruction could result in electrical shocks and severe injuries.
- 5- Do not subject this light panel to outdoor, high humid and vaporized area.
Failure to observe this instruction could result in breakdown.
- 6- Keep this out of the direct rays of the sun. Failure to observe this instruction could result in color changes of acrylic plate.
- 7- Keep away from fire or severe hot place. Acceptable ambient temperature is max.35°C Failure to observe this instruction could result in shorten the life time and degradation of brightness of LED light source.

- Please inform the order number on the product or on the carton (e.g. 1/110001394-460) to the place that you have made the purchase if any problem with the product occurs.
- All rights reserved. All pictures, figures and writings are secured internationally by copy-right law. Infringements will be sued by civil and legal law.

This technical sheet's contents are all subject to update and modification at MT Displays' exclusive discretion. There is nothing official about this document. For final and legally binding information, please get in touch with the sales staff at MT Displays.



T: +90 850 433 67 85 / info@mtdisplays.com / www.mtdisplays.com